

SICO X-Press® Stage & Riser

The Sico X-Press® is a stage and riser system designed to meet a facility's ever-changing needs. The X-Press® converts easily from one application to another without the necessity of lifting heavy folding leg units.

Built to Stand-Up to your Needs:

- The Sico deck is structural, light-weight, and quiet. These features are made possible by a special resin impregnated honeycomb core, a solid edge, and complimented by our standard hard surface or carpeted surface.

Lightweight Frame & Deck:

- The lightweight frames and decks allow for ease of handling. Available in 4' x 8' (122cm x 244cm) or 3' x 8' (91cm x 244cm) to meet your particular requirements. 3' x 8' units (91cm x 244cm) are recommended for riser configurations.

3



- Mobile caddies are available which hold up to 8 decks and frames, or 256 sq. ft. (24 sq.M) of staging for ease of storage and transport.

- Exclusive expanding rubber gasket at the base of each flex pin allows decks to be secured to the frames and sit flush with the deck surface.

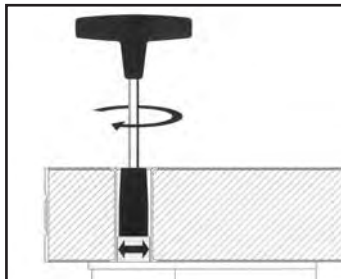

- Choose between a standard black hard surface, or a choice of carpet colors. Single sided or reversible decks are available.



- Snap action lock secures deck sections together in a stage or riser set-up.

Sturdy:

- 14 gauge unitized steel frame for long lasting strength and durability.
Meets or exceeds industry standards!

Flexible:

- Available in a variety of heights with 6” (15cm) increments to meet ADA requirements.

Accessories:

Adjustable step units, ADA ramps, guard rails, guard rail covers, and drapes.

Service:

- Sico offers free space analysis drawings, which will provide accurate layouts for your venue with the appropriate number of stages and stage accessories.

Specifications:

- See specifications on page 11.



- Center frame legs have two adjustable glides to help level the stage on uneven surfaces.



- Heights are easily set with adjustable pull pins.

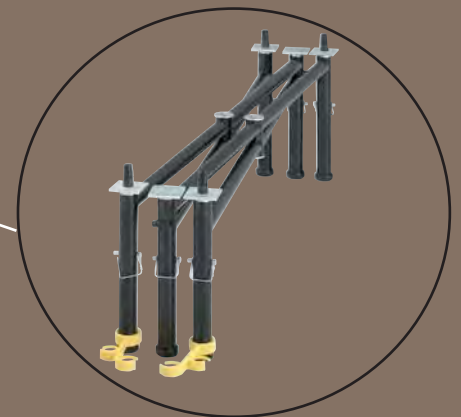

- The compact, light-weight frame is set in place, unfolded, and automatically assumes the correct position for attaching the deck.