

FRONT VIEW - TOP FLAT

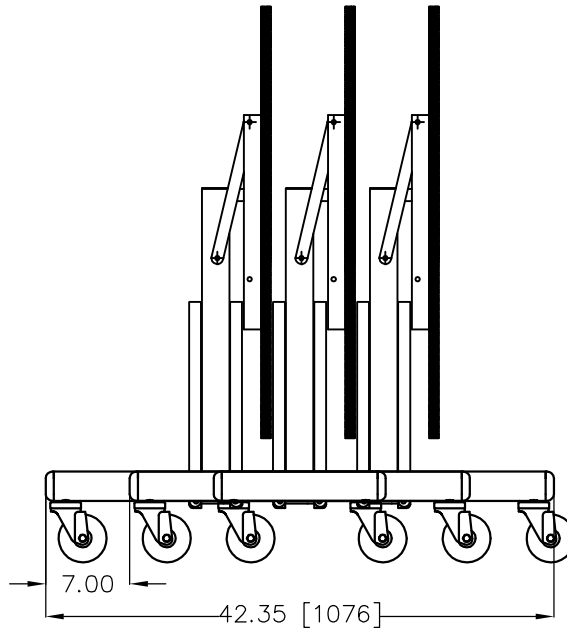

STORAGE LAYOUT

EACH TABLE ADDS 7.0" [178MM] TO STORAGE REQUIREMENTS

SUPPORT & CASTER BEAM 16Ga or heavier C1020 Steel Tube.

TOP FRAME: .10" Thick 6061-T6 Extruded Aluminum

SUPPORT ARMS/RACK: 1/8" 1/8" or heavier steel. Rack PVC coated.

METAL FINISH: Exposed tubular steel parts may be chrome plated or powder coat painted depending on model ordered.

FASTENERS: 5/16" & 3/8" Hex head cap screws with aircraft type lock nuts.

TOP: Top shall be of 3/4" MDF core with .030" high pressure melamine top surface and black polyethylene backing sheet. Edges to be finished with sprayed on black textured polyurea.

TOP ATTACHMENT: Top and leaves attached to frame members with 1/4" diameter expansion rivets.

HINGES: Three position design [Tri Fold] with 180° pivoting & self locking leaf-up feature. All steel construction, zinc plated finish.

CASTERS: 4" Single wheel casters with gray thermoplastic rubber tread. Body of caster to be nickel plated steel. 275 lb. load rating per caster.

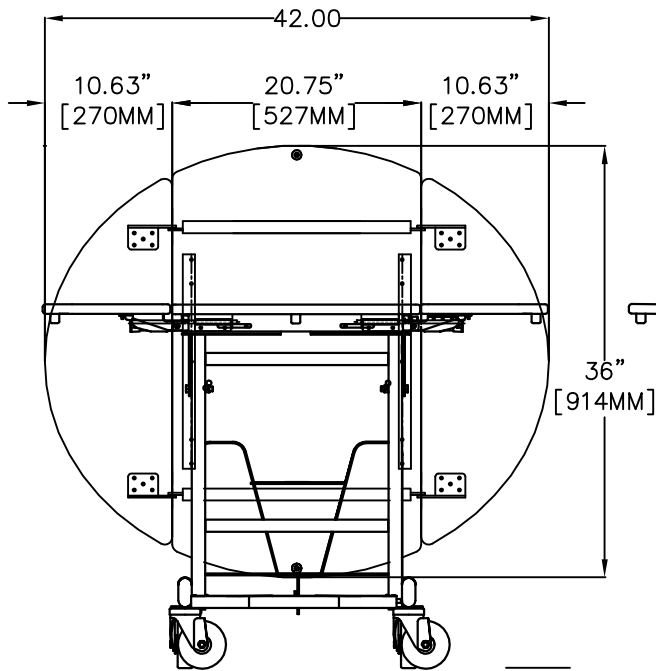

FRONT VIEW - TABLE FOLDED

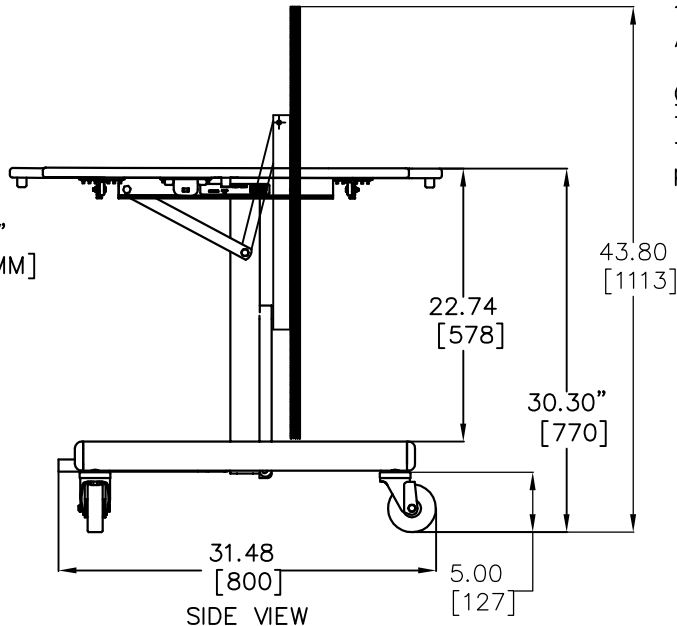

SIDE VIEW

REV B	ECO NA	DATE 15JAN08	BY DJB
DETAILS REVISED SPEC FOR SERIES 6 ADDED NEW CASTER SPEC			

DO NOT SCALE DRAWING

REVISION

SICO COPYRIGHT 2001	DATE 15JAN08
	DRAWN BY DJB
TOLERANCES ARE NON-ACCUMULATIVE DIMENSIONS ARE IN INCHES AND [MM'S] UNLESS OTHERWISE NOTED TOLERANCES ARE: .XXX ±.0005 .XXX±.010 .XX ±.030 ANGLES ± 1° FRACTIONS ± 1/32	CHK'D BY
	SCALE U/M NTS .
ROOM SERVICE TABLE .TRI-FOLD & BI-FOLD	FINISH
SPECIFICATION	REV B
	SHEET 1 of 1