

**TO OPEN**

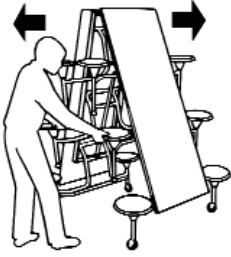

**1** Release transport lock. Grasp middle stools, force outward.

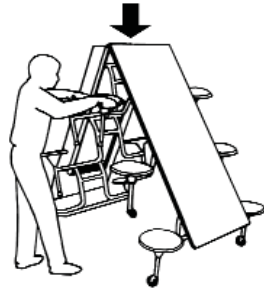

**2** As table starts to open, push stools downward toward floor.

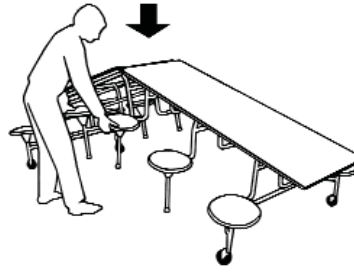

**3** Retain grip on stools, ease table down. Align in position before table legs reach floor.

**TO FOLD**

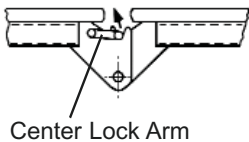

**1** Raise center lock arm and hold against table top. Grasp a stool and lift table slightly.

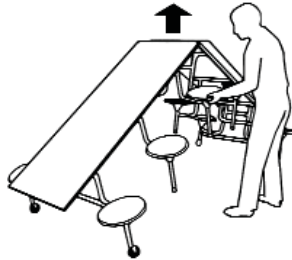

**2** Grasp two stools at center of table. Lifting with your legs, raise table with continuous upward motion.



**3** To close, grasp edges of stools and pull toward center. Make sure lock is engaged.

**WARNING**

To be moved and operated only by an adult. Before moving, engage the transport lock to prevent tipping. Failure to follow warnings may result in serious injury or death.

**TO ROLL**

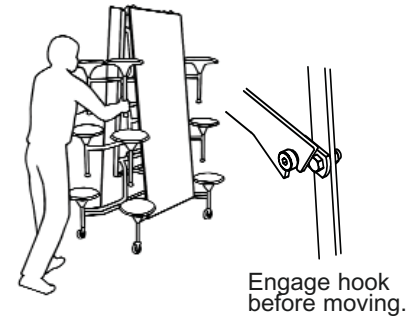

**WARNING**

To avoid table tipping over, push from end of table. DO NOT push from side. Avoid debris on floor.

ITEM	DESCRIPTION
2	Leg Weldment, outside
3	Bar, tension
5	Bar, X
9	Top
10	Frame Weldment, top
11	Leg Weldment, inside
20	Caster, 4"
22	Cap, Screw, 1/2" x 1"
24	Locknut, 1/2"
25	Pushnut, flat
32	Arm, lock
34	Cap Screw, 3/8" x 1"
38	Tube Cap, 1"
39	Glide, black, 1"
40	Rivet, drive
42	Cap, Screw, 3/8" x 1-1/4"
43	Screw, drive, #6 x 1/4"
44	Locknut, 3/8"
45	Pushnut, 3/8" hat
46	Tube Plug, 1"
47	Bar, torsion
47	Housing
48	Pushnut, flat, 3/8"
57	Clip
58	Locknut, 3/8" Thin
59	Shoulder Bolt
60	Hook
61	Lock Rod
62	Vinyl Cap, 5/8"
90	Stool
91	Self-locking Pin
92	Backrest Assembly
93	Backrest
94	Arm, backrest support
95	Plate, stool
96	Stool Assembly, old style
97	Stool, flat
98	Screw, #14 x 5/8"

**MAINTENANCE:** Oil pivot points every six months. Wash tops with soap and water.

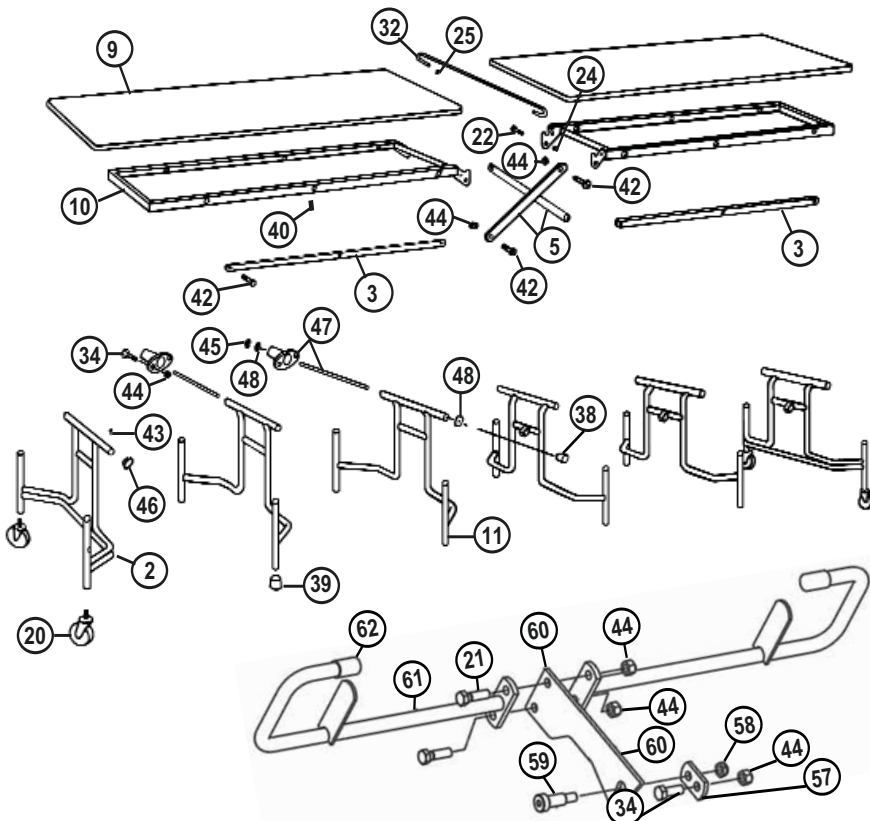

**When Ordering:**

All Parts. Indicate table Serial No., height, length, Serial No. is on frame, near center of table. Tops. Indicate color, size. Legs. Indicate table height. For parts or pricing, contact your local dealer or SICO Customer Service.

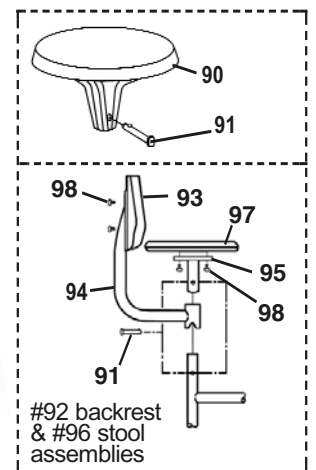

## TC-65 Stool Installation Instructions

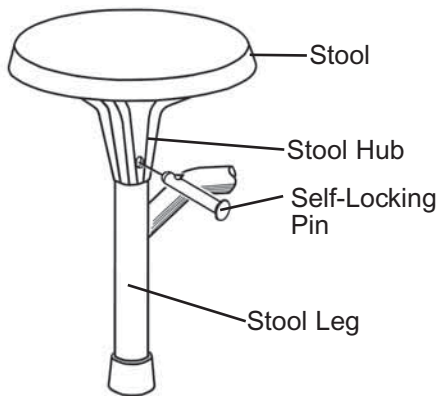

1. Slide the stool over the top of the stool leg.
2. Align the holes in the stool hub with the holes in the stool leg.
3. Orient the Self-Locking Pin with the detent facing up and slide it through the holes of the stool and stool leg until detent activates. The sides of the pin-heads should fit between the ribs of the stool hub.

**CAUTION:** Self-Locking pin must be installed to prevent excess wear on stool.

## TC-65 Stool and Backrest Installation Instructions

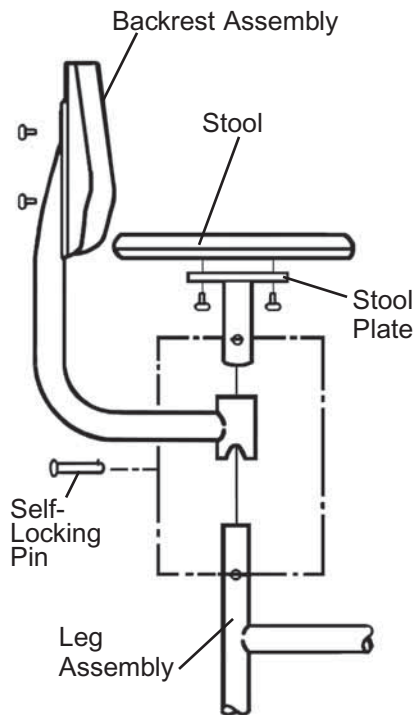

1. Slide the backrest assembly over the stool leg.
2. Insert the stool plate through the backrest and over the leg.
3. Hold up the backrest and align the holes in the stool plate and the leg.
4. Orient the Self-Locking Pin with the detent facing up and slide it through the holes of the stool plate and stool leg until detent activates.
5. Let the backrest slide down and rest on the pin.
6. Rotate the backrest until its notches rest on the pin.

**CAUTION:** Self-Locking Pin must be installed to prevent excess wear on the stool plate.

**To reverse the backrest 180°**, grasp the seatback, pull up about 1", then rotate it.